

# Young Guns

## MATT THOMAS, AIA, ARCHITECT

Matthew Thomas Architecture, LLC, Scottsdale  
Age: 35

### *How did you get into this line of work?*

I have loved houses for as long as I can remember. As a child, I was often involved in some project around the house. Later, I put myself through college by framing custom homes. In early 2008, I left a premier architecture firm to start my own company, focusing on custom homes and remodels.

### *What inspires you?*

Certainly, inspiration can come from a number of places: a site with great views or unique natural features, a charming neighborhood, a timeless home, or a faraway place. For me, inspiration often comes from the stories and dreams of the families I work with. I also draw a lot of inspiration from the craftsmanship that went into the classic revival-style homes built during the early 20th century.

### *What is your design philosophy?*

I approach each project individually, knowing every home will have a unique solution. A successful project requires learning how a family lives in their home and listening closely as we discuss the client's needs and desires. I strive to design homes that aesthetically stand the test of time and work well within the context of the site or neighborhood.

### *What is your biggest design accomplishment to date?*

Anytime you can take the dreams of a client and clearly translate those into a graphic representation that ultimately becomes the home they live in and love, you have accomplished something of worth.

### *What's on the horizon?*

Continuing to hone the craft of designing beautiful new homes and remodels throughout Arizona.

**Below:** Planned for a Paradise Valley, Arizona, home, the wine room in the architect's sketch has a brick groin-vaulted ceiling. The space is fitted with built-in hutches and wine racking, which Matt Thomas describes as a "loose furniture" look.

**Bottom:** Located in the Arcadia neighborhood, this French Country home displays the style's distinctive sloped hip roof. Other elements include painted shutters, gas lanterns and a shake roof with copper spires. The beam-ceilinged family room is divided from the kitchen (background) by a wide plaster arch accentuated at each end with hand-formed plaster corbels.

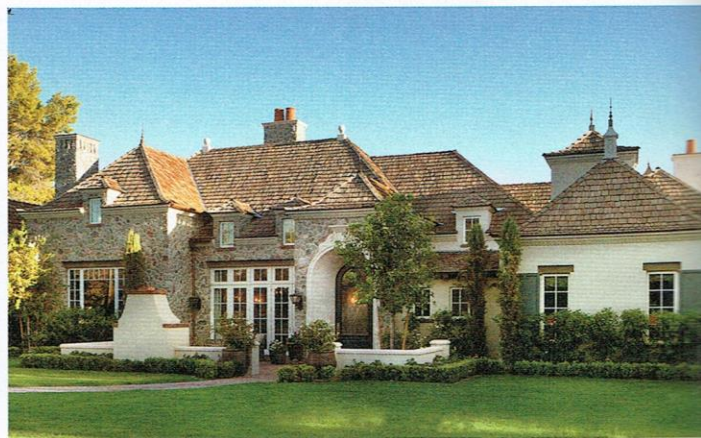
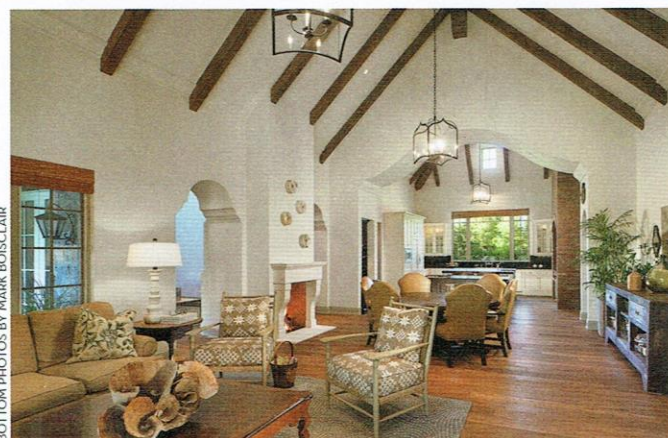
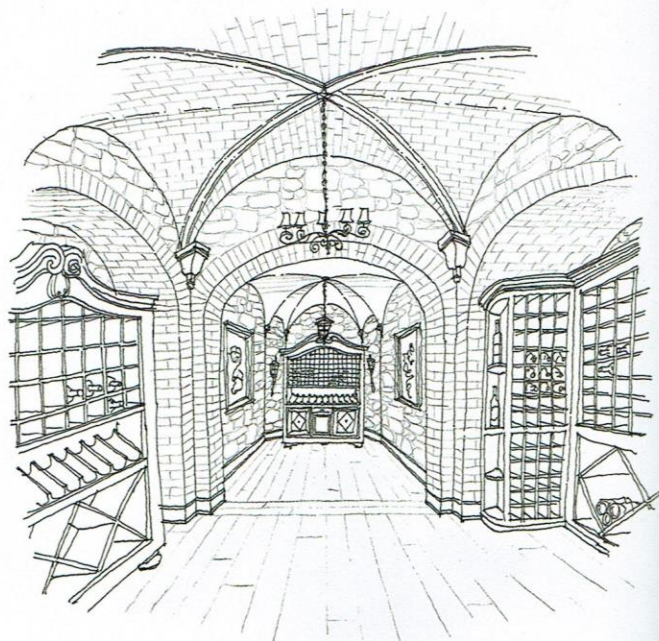

BOTTOM PHOTOS BY MARK BOISCLAIR

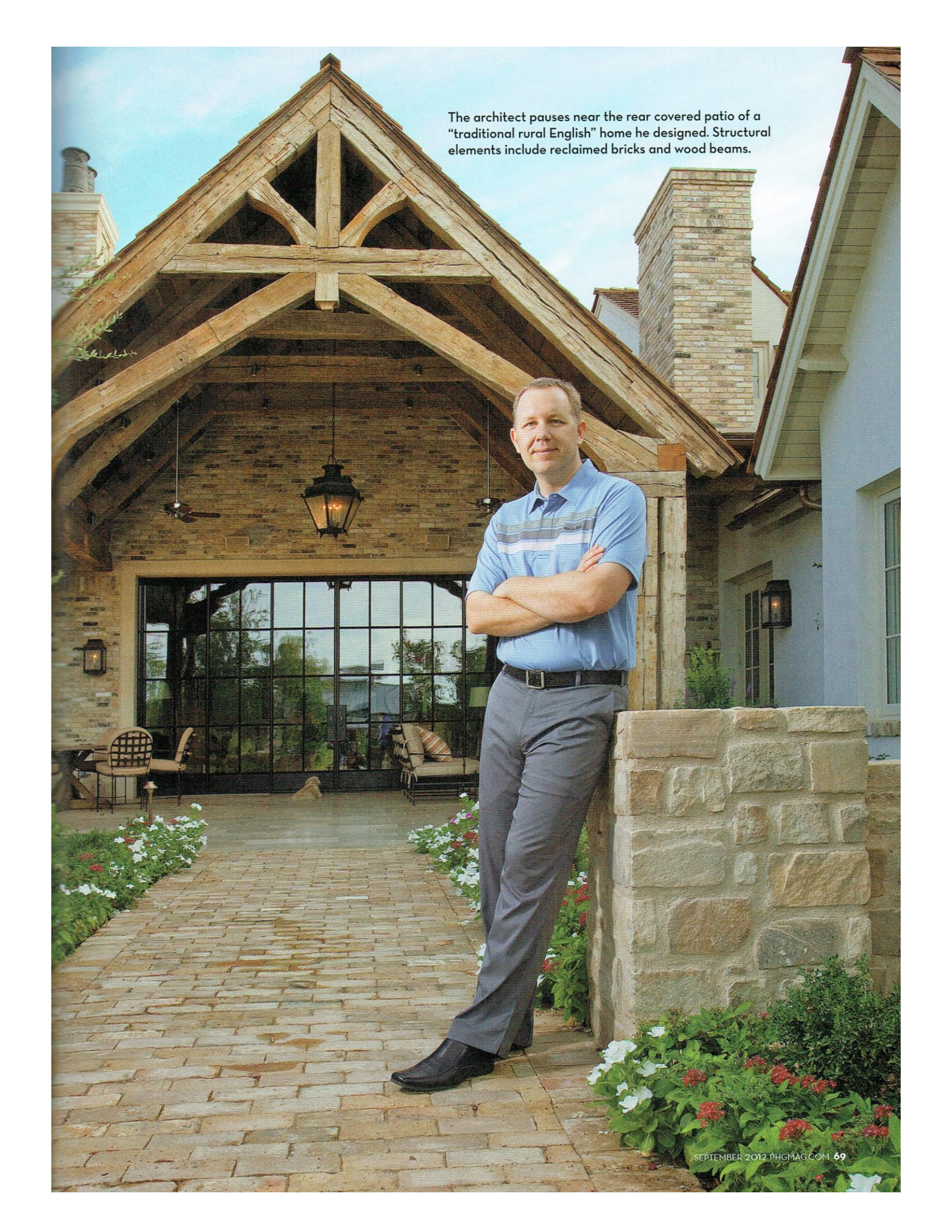

A man with short brown hair, wearing a light blue polo shirt with thin horizontal stripes and grey trousers, stands with his arms crossed in a large, covered patio. The patio has a high, vaulted wooden ceiling with exposed beams and a brick wall. A large glass door is in the background. The man is leaning against a stone wall. The ground is paved with stone tiles, and there are plants and flowers around. The sky is blue with some clouds.

The architect pauses near the rear covered patio of a “traditional rural English” home he designed. Structural elements include reclaimed bricks and wood beams.